

THIS DRAWING IS UNPUBLISHED. RELEASED FOR PUBLICATION
 © COPYRIGHT - BY TYCO ELECTRONICS CORPORATION. ALL RIGHTS RESERVED.

LOC	DIST	REVISIONS					
		P	LTR	DESCRIPTION	DATE	DWN	APVD
G	14		A2	REV PER ECR 08-011184	02MAY08	JR	TM

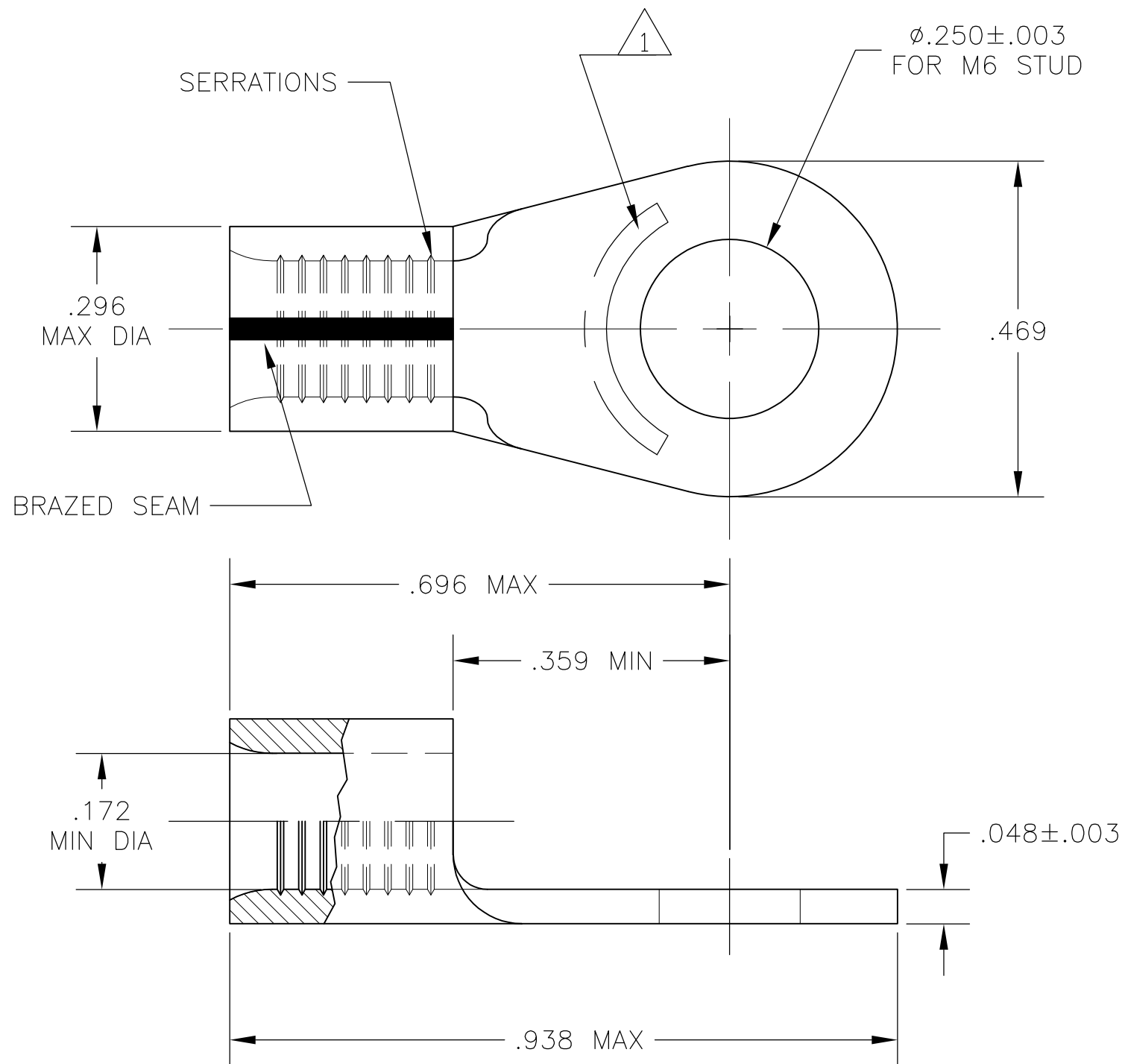

- 1 STAMP AMP 8, APPROX AS SHOWN
- 2 MAX RECOMMENDED OPERATING TEMP. IS 170°C MAX
- 3 VOLTAGE RATING IS NOT APPLICABLE
- 4 WIRE CROSS SECTIONAL AREA RANGE: 13,100-20,800 CMA / 6.64-10.5mm²
- 5 COPPER PER ASTM B-152, ANNEALED
- 6 .000100 MIN TIN PLATE PER ASTM B-545

6	130550
FINISH	PART NO

THIS DRAWING IS A CONTROLLED DOCUMENT.		DWN jr_ruth 13FEB06	Tyco Electronics Corporation Harrisburg, PA 17105-3608		
DIMENSIONS: INCHES		CHK T MICHELUTTI 13FEB06			
		APVD T MICHELUTTI 13FEB06	PRODUCT SPEC -		
TOLERANCES UNLESS OTHERWISE SPECIFIED:		APPLICATION SPEC -			
0 PLC ± -		SIZE A3			
1 PLC ± -		CAGE CODE 00779			
2 PLC ± -		DRAWING NO G-130550			
3 PLC ± .008		RESTRICTED TO -			
4 PLC ± -		SCALE 5:1			
ANGLES ± 5°		SHEET 1 OF 1			
MATERIAL - 5		WEIGHT -			
FINISH SEE TABLE		REV A2			
CUSTOMER DRAWING					